

# Toxoplasma Antibody (TOXO Ab) Rapid Test Kit

## Technical Manual

(GICA)



Scan for more info.

Shenzhen Finder Biotech Co.,Ltd.

Web: www.szfinder.com

Tel: +86 0755 23499025

Email: techsupport@szfinder.com

Add: Building B12, Life Science Industrial Park, Kuiyong Subdistrict,  
Dapeng New Area, Shenzhen, China

## Product Information

### Intended Use

This test kit is used to detect IgG and IgM antibodies against Toxoplasma gondii (TOXO) in canine and feline blood samples.

### Principle

The kit uses colloidal gold immunochromatography assay (GICA) for the detection of IgG and IgM antibodies against TOXO. After adding the diluted sample to sample hole ("S"), if antibodies against TOXO are present in the sample, they will specifically bind to the colloidal gold-labeled antigen, forming a complex that moves along the nitrocellulose membrane. It is then captured by the protein coated on the membrane, which makes the T1 line and T2 line colored. If there are no antibodies against TOXO in the sample, the T1 line and T2 line will not appear. Regardless of a negative or

positive result, the control ("C") line should always appear, or else the result is considered invalid.

Package specification	20T/Kit
Test device	20
Capillary tube	20
Assay buffer	1
Instruction	1

### Storage Conditions

Store in a cool and dry place at temperatures between 2°C to 30°C (35.6°F to 86°F). Avoid freezing.

The shelf life is 24 months from the date of manufacture, which is indicated on the label of the box.

## Preparation of Sample

Collect fresh whole blood, serum or plasma samples and ensure that the samples cannot be turbid or have precipitates.

## Test Methods

- 1) Open the foil pouch, take out the test card and put it on a flat and clean work surface.
- 2) Draw the prepared sample with capillary tube until the liquid level is flush with the capillary scale line (about 10µL), and slowly add it into the sample hole ("S"); Then immediately add 3 drops (about 90µL) assay buffer in the sample hole, and start timing.
- 3) Allow the test card to sit at room temperature for 5-10 minutes to determine the results. Results obtained after 15 minutes are considered invalid.

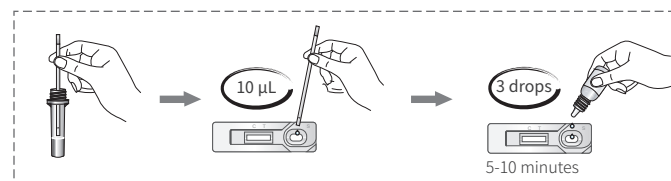

## Results Judgement

**T1=IgG** (T1 is the test line for IgG antibodies against TOXO.)

**T2=IgM** (T2 is the test line for IgM antibodies against TOXO.)

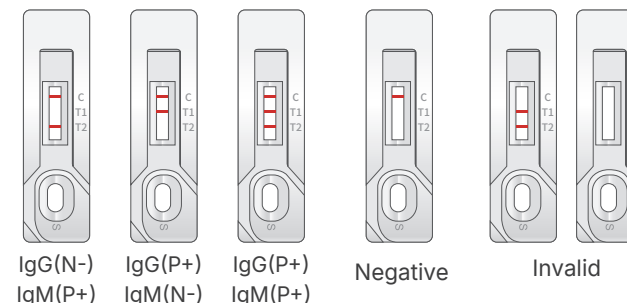

**Negative(N-):** Only control ("C") line appears in the result window.

**IgG positive (P+):** Both T1 line and control ("C") line appear in the result window. It indicates that IgG antibodies against TOXO are present in the sample.

**IgM positive (P+):** Both T2 line and control ("C") line appear in the result window. It indicates that IgM antibodies against TOXO are present in the sample.

**Invalid:** If the control ("C") line does not appear, the result might be considered invalid.

## Results Interpretation

1) A negative test result indicates that there are no TOXO antibodies detected in the sample, and TOXO infection cannot be ruled out if there are corresponding symptoms.

2) A positive test result indicates the presence of antibodies against TOXO in the sample tested, suggesting a potential infection by the TOXO. Further analysis is required, integrating clinical data and other

diagnostic methods.

dispose of them properly in accordance with the relevant local regulations.

### | Limitation of the Test Method |

Although this kit is highly accurate in detecting antibodies against TOXO, there is still a possibility of occasional false results. If uncertain or questionable results are obtained, additional clinical or laboratory tests may be necessary. As with other diagnostic tests, a definitive clinical diagnosis should not rely solely on the outcome of a single test. Instead, it should be made by the veterinarian after evaluating all clinical and laboratory findings. By considering a comprehensive assessment, veterinarians can ensure a more reliable and accurate diagnosis and provide appropriate care and treatment for the animal.

### | Notice |

- 1) Please read the instructions carefully before testing. And a variety of reagents are only used for this experiment.
- 2) Avoid using expired or damaged products.
- 3) The kit should be allowed to return to room temperature after being removed from the refrigerator before opening. Once opened, it should be used as quickly as possible to avoid becoming ineffective due to moisture.
- 4) Avoid touching the white nitrocellulose membrane of the result window.
- 5) Avoid touching the sample hole.
- 6) Avoid direct sunlight and direct blowing of electric fans during detection.
- 7) The capillary tube is not reusable to avoid contamination.
- 8) The waste shall be regarded as pollutants. Please