

# Feline Calicivirus Antigen (FCV Ag) Rapid Test Kit

## Technical Manual

(GICA)



Scan for more info.

Shenzhen Finder Biotech Co.,Ltd.

Web: www.szfinder.com

Tel: +86 0755 23499025

Email: techsupport@szfinder.com

Add: Building B12, Life Science Industrial Park, Kuiyong Subdistrict, Dapeng New Area, Shenzhen, China

## Product Information

### Intended Use

This test kit is used to detect Feline Calicivirus (FCV) in secretions from the mouth, eyes, nose, and anus of cats. It can be used for screening and auxiliary diagnosis of FCV infection.

### Principle

The kit uses colloidal gold immunochromatography assay (GICA) for the detection of FCV antigen. After adding the diluted sample to sample hole ( "S" ), if FCV antigens are present in the sample, they will specifically bind to the colloidal gold-labeled monoclonal antibody against FCV, forming a complex that moves along the nitrocellulose membrane. It is then captured by the FCV monoclonal antibody coated on the membrane, which makes the test ( "T" ) line colored. If there are no FCV antigens in the sample, the test ( "T" ) line will not appear.

Regardless of a negative or positive result, the control ( "C" ) line should always appear, or else the result is considered invalid.

### Content

Package specification	20T/Kit
Test device (with disposable dropper)	20
Assay diluent	20
Sampling Swab	20
Instruction	1

### Storage Conditions

Store in a cool and dry place at temperatures between 2°C to 30°C (35.6°F to 86°F). Avoid freezing.

The shelf life is 24 months from the date of manufacture, which is indicated on the label of the box.

## Preparation of Sample

- 1) Collect cat' s ocular, nasal or anus secretions with the sampling swab and make the swab wet sufficiently.
- 2) Immediately insert the swab into the assay diluent tube. Agitate the swab thoroughly until the sample is fully dissolved in the diluent. Squeeze out the excess liquid from the swab against the wall of the tube and discard the swab. The liquid obtained after allowing it to stand within the tube is the treated sample.

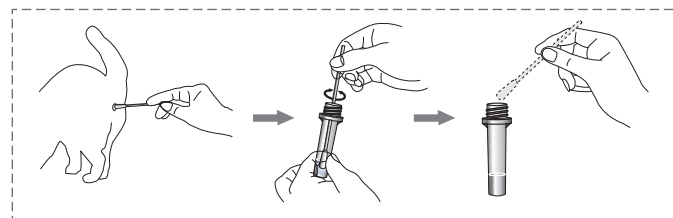

## Test Methods

- 1) Open the foil pouch, take out the test card and put it on a

flat and clean work surface.

2) Using the provided dropper, aspirate the clarified supernatant from the **treated sample**. Carefully and vertically dispense 3 drops (approximately 60 µL) into the sample hole ( "S" ).

3) Allow the test card to sit at room temperature for 10 minutes to determine the results. Results obtained after 30 minutes are considered invalid.

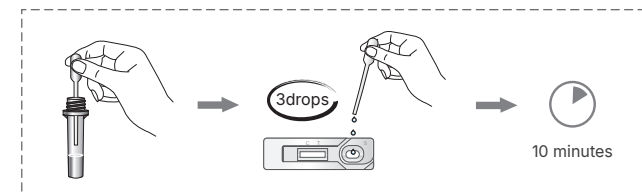

## Results Judgement

**Negative:** Only control ( "C" ) line appears in the result window.

**Positive:** Both test ( "T" ) line and control ( "C" ) line appear in the result window.

**Invalid:** If the control ( "C" ) line does not appear, the result might be considered invalid.

(Note: Water, PBS, and other animal serum cannot be used as negative controls.)

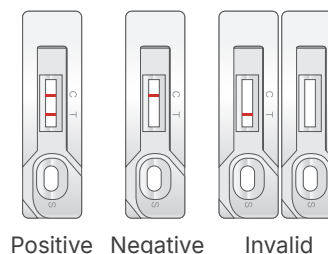

## Results Interpretation

- 1) A negative test result indicates that there are no FCV antigens detected in the sample, and FCV infection cannot be ruled out if there are corresponding acute symptoms.
- 2) A positive test result indicates the presence of FCV

antigens in the sample tested, suggesting a potential infection by the FCV. Further analysis is required, integrating clinical data and other diagnostic methods.

### **| Limitation of the Test Method |**

Although Feline Calicivirus Antigen Rapid Test Kit is highly accurate in detecting FCV antigens, there is still a possibility of occasional false results. If uncertain or questionable results are obtained, additional clinical or laboratory tests may be necessary. As with other diagnostic tests, a definitive clinical diagnosis should not rely solely on the outcome of a single test. Instead, it should be made by the veterinarian after evaluating all clinical and laboratory findings. By considering a comprehensive assessment, veterinarians can ensure a more reliable and accurate diagnosis and provide appropriate care and treatment for the animal.

### **| Notice |**

- 1) Please read the instructions carefully before testing. And a variety of reagents are only used for this experiment.
- 2) Avoid using expired or damaged products.
- 3) The kit should be allowed to return to room temperature after being removed from the refrigerator before opening. Once opened, it should be used as quickly as possible to avoid becoming ineffective due to moisture.
- 4) Avoid touching the white nitrocellulose membrane in the middle of the result window.
- 5) Avoid touching the sample hole.
- 6) The waste shall be regarded as pollutants. Please dispose of them properly in accordance with the relevant local regulations.